

Heavy Duty Trolley

SN&I had a challenge to maneuver 59 large blast plates to the work front down narrow concrete corridors. The plates were 1.1m deep 38mm thick 4.2m long and weighed in excess of 1.35T. There was nothing on the market which could meet the strict safety requirements for the site so a specialized trolley was designed and fabricated.

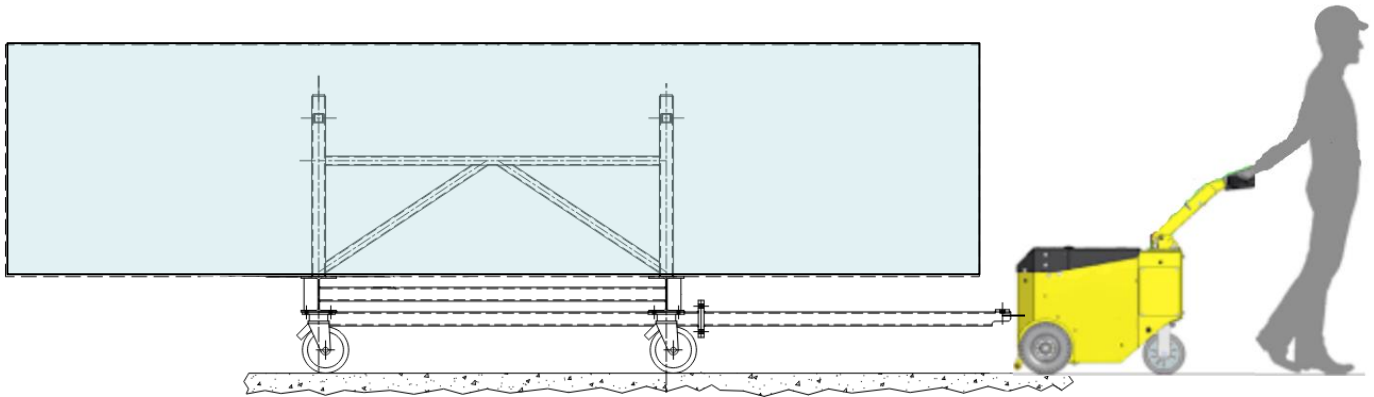

Trolley and Tow

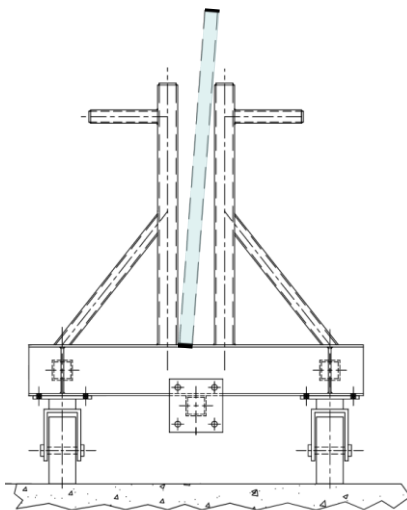

End View of Trolley



Completed Trolley

Key Points

1. Handles were provided to allow the trolley to be manipulated through the tight corridors.
2. A central slot was created in the trolley to support the plate.
3. An AT200 Tow machine was used to move the trolley.
4. The Tow machine had a dead man switch to prevent the load accidentally moving.
5. Heavy duty nylon castors were used to prevent damage to the finished floor.
6. The Tow arm was removable to allow easy delivery and manipulation around corners.
7. The frame was made from UC main bearers and small hot rolled box sections.
8. The frame is fully welded construction and the wheels bolted in place.
9. All 4 wheels were fitted with breaks.

For More Information Contact Chris Achilles (Severfield SN&I) 01204 558500