

Workable Space - Importance of Visual Representation

On a recent project the PM Group used 3D modelling to help get the best possible result for the relocation of existing offices and the creation of a new QC lab facility. The new layout had to be efficient, safe, operational and ergonomic. Careful consideration was given to how the space was used by identifying:-

- Spatial requirements for bringing equipment in and out.
- Operational distances between equipment.
- Distance requirements to avoid disturbance to equipment by other users.

To help achieve the best solution a 3D workable model was built with simple box zones to represent the space required to achieve each task. The scheme was then reviewed and tweaked to ensure that the optimum solution was selected.

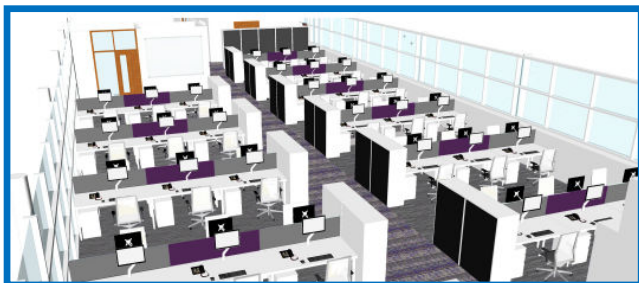
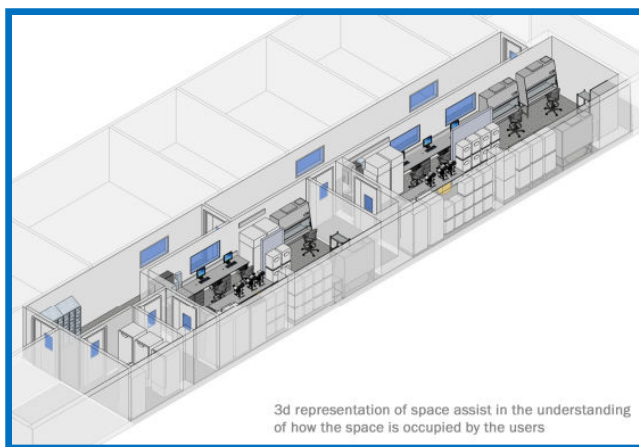

3D Model Views

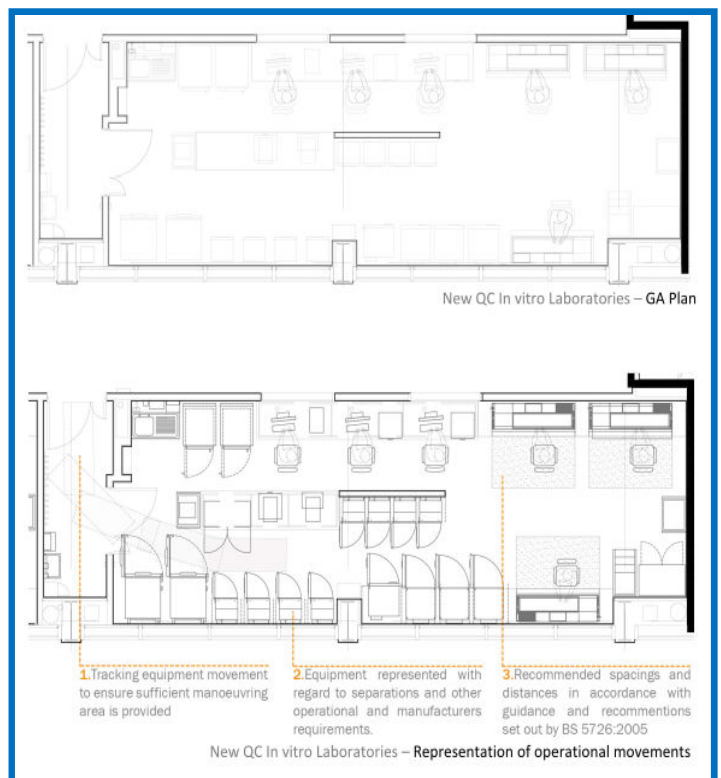

2D Plan Movement Drawings

Key Points

- Engage the end user early to fully understand their requirements.
- Use 3D modelling software to plan your space economically.
- Simple 2D plan drawings can be produced to show overall movement areas.
- Track equipment movements to ensure sufficient space is provided.
- Think about possible future maintenance issues and equipment replacement.

For Further Information Contact Aranzazu Lera (PM Group) Tel – 0121 767 6700