

## Simplified Sleeve in lieu of Complex Wall Box

This scheme was devised to provide a simple sleeve detail that minimised the amount of site work.

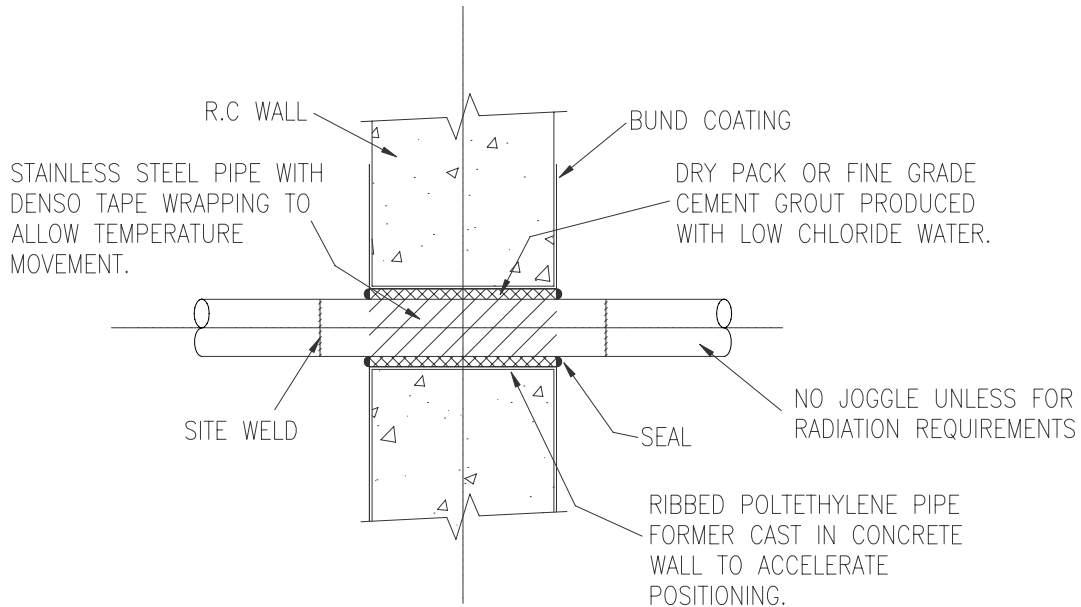

TYPICAL PENETRATION DETAIL

### **The proposal is: -**

- Design pipe configurations and determine pipe penetrations locations precisely for all prefabricated skids/ support frames/ tanks.
- Install oversize penetration sleeve in concrete shutters to accurate predetermined locations.
- Fix wall and roof reinforcement round sleeves.
- Pour concrete.
- Install pipe assembly fabrications and weld in spool connections.
- Fill gap between pipe and sleeve with dry pack concrete or fine grade cement grout produced with low chloride water.

Doing this removes the need to design and install complex wall boxes and makes fire protecting the opening much easier.

*For further information contact Joey Pang, Tel – 0161 477 0766*