

Quicker Steel Drilling

Most fabrication companies of any size have an automated cut and drill line. This offers multi-head automated drilling of steelwork using CNC files downloaded from computer generated models from Strucad or Xsteel.

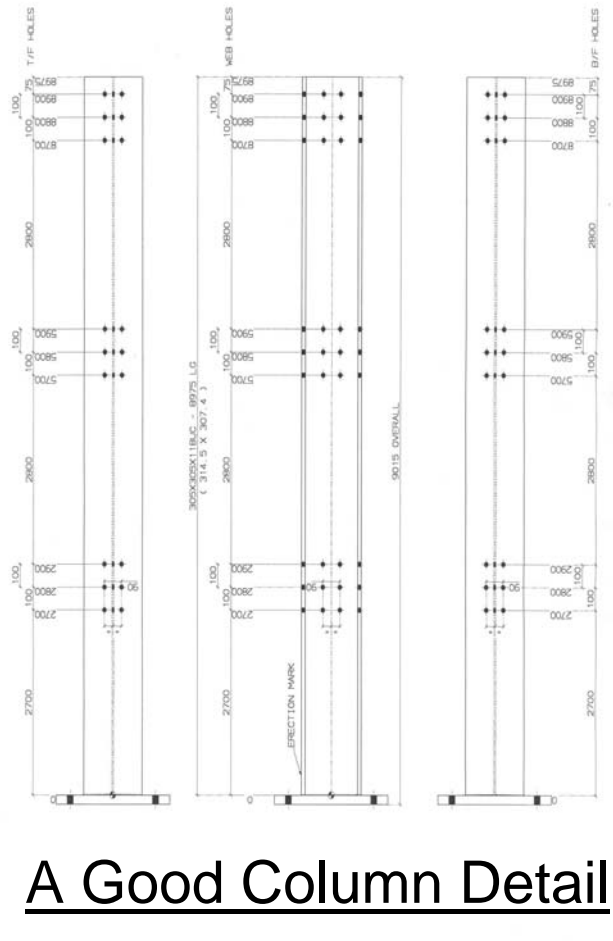
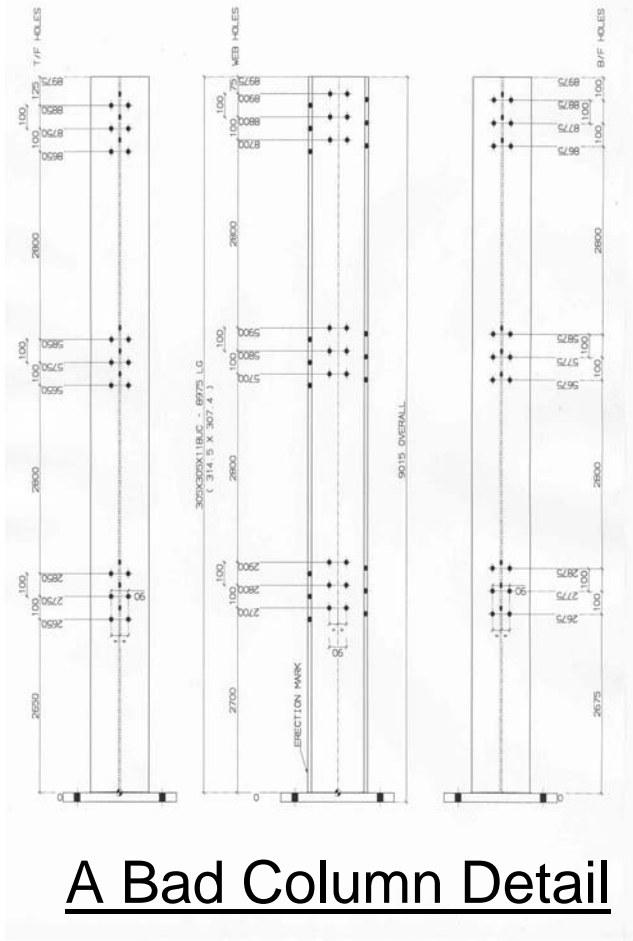

Key Points:-

1. Keeping holes in line means that all faces can be drilled at the same time.
2. Members could be drilled up to 3 times faster.
3. Fabricators recover all or most of their overheads on the shop hours. Saving time in fabrication is a top priority if you want to be competitive.
4. It's surprising how many detailers do not realize that if the holes are in line in opposite flanges and the web, this means quicker drilling.
5. Some plates may end up none symmetrical but you have to weigh up symmetry verses shop time. Shop time will usually come out on top.

For further information contact Chris Achilles (Peers) – Tel 01204 528393.